

SLOT READERS

Accurate
Accurate
Considerate
Considerate



1030 1036 Magnetic Card Reader/Writer
1023 1024 Magnetic Slot Readers



1002 1022 Barcode Slot Readers



- Light Weight, Heavy Duty and Reliable
- Multiple interfaces available

- 1002 Rugged Metallic Housing for Harsh Environments
- 1022 MTBF: 100,000 times, Plastic Housing
- 1023 1024 Supports Single, Dual and Triple Tracks, Data Editing Mode
- 1030 Read High & Low / Write Low Coercive of magnetic stripe
- 1036 Read/Write High & Low Coercive force of magnetic stripe (300-4000Oe)

1002 BARCODE SLOT READER

1022 BARCODE SLOT READER

Specifications

Models	1002	1022WM (Wand Module) 1022W (Wand Emulation)	1022R (RS-232) 1022K (Keyboard Wedge)			
Electrical	Voltage	5V +/- 10%				
	Power Consumption	1022WM	1022W	1022K	1022R	
	Operation (Maximum) (Typical)	<50mA <35mA	<50mA <35mA	<70mA <50mA		
Environmental	Temperature	0°C~40°C (operating)				
		-20°C~60°C (storage)	-40°C~60°C (storage)			
	Humidity	5%~95% (non-condensing)				
Physical	Weight (cable not included)	252g	1022WM: 38g	1022W: 89g	1022K: 130g	1022R: 144g
	Housing	Metallic	ABS Plastic			
	Dimensions	91(L)\X33(H)\X36(W) mm	1022WM	90.4(L)\X24(H)\X32.8(W) mm		
			1022W/K/R	90.4(L)\X28.4(H)\X37.2(W) mm		
	Connector	DB9F / AMP9F	Molex 5pin / DB9F / DB25F / AT/PS2			
Optical	Light Source	Infra-Red (940nm) Visible Red (660nm)				
	Resolution	0.15mm				
	Card Thickness	0.5-1.5mm				
	Minimum PCS	0.5				
	Scanning Speed	100-1000 mm/sec				
	Scanning Position	9 mm from slot bed	11mm from slot bed			
Features	Output Interface	Wand Emulation	Wand Emulation, Keyboard Wedge, RS232, RS-232			
	Keyboard Interface		IBM PC/XT/AT & compatible, PS2-30, PS-55			
	Symbology Supported		1022R / 1022K Code 39/Full ASCII, Codbar, Pharma Code, Industrial 2 of 5, Interleave 2 of 5, Matrix 2 of 5, Code 93, Code 128, EAN 128, MSI, EAN 8 & 13, UPCA & E, Plessey			
	Programmable Features		Code ID, Prefix Code, Postfix Code, Length Code, Barcode type.			
Pin Assignment	1	Vcc, +5V				
	2	Signal				
	3	Ground				
	4	No connection				
	5	Good Read LED				
Safety & Regulatory Approvals	FCC class-A, CE, C-tick					

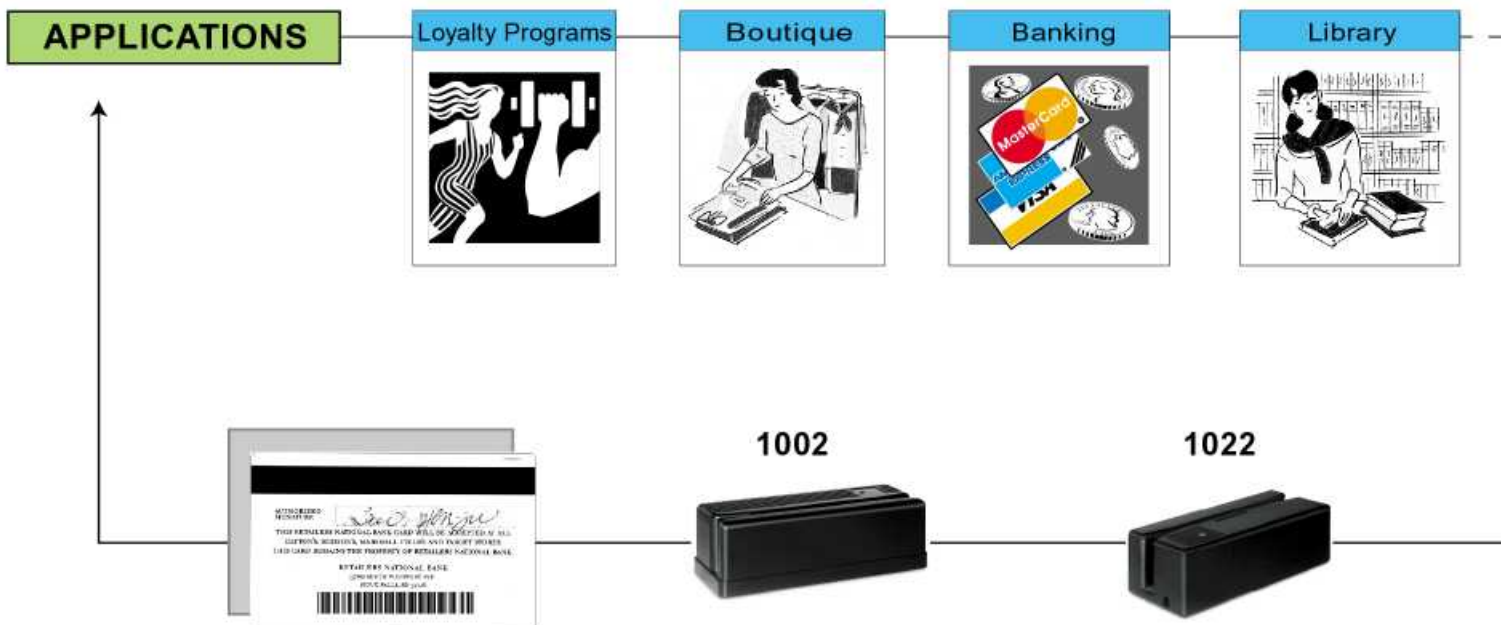

1023 1024 MAGNETIC SLOT READER

1030 1036 MAGNETIC CARD READER/WRITER

Specifications

Models	1023			1024			1030	1036	
	Single Track Dual Track Triple Track	Track 1 Track 2 Track 3 Track 12 Track 23 Track 123		Track 1 Track 2 Track 3 Track 12 Track 23 Track 123			Track 123		
Electrical	Voltage	5V +/- 10%					9V +/- 10%	24V +/- 5%	
	Power Consumption Operation (Maximum) (Typical)	<30mA <25mA		<30mA <25mA			250mA plus for each writing track <300mA	500mA plus for each writing track <350mA	
Environmental	Temperature (operating)	0°C~50°C		-10°C~50°C			-10°C~60°C		
	Temperature (storage)	-20°C~60°C		-30°C~70°C			-30°C~70°C		
	Humidity	5%~95% (non-condensing)		10%~90% (non-condensing)			10%~90% (non-condensing)		
Physical	Weight (cable not included)	170g		180g			1kg	1.5kg	
	Dimensions	163(L)\X44(H)\X47(W) mm		95(L)\X36(H)\X34(W) mm			200.4(L) 55.7(H) mm 60.4(W)	200(L) 59(H) 55(W) mm	
	Housing	ABS Plastic		ABS Plastic			ABS Plastic		
	Color	Ivory		Pearl White			Ivory		
Features	Interface Type	RS232, Dual RS232, Keyboard Wedge		RS232, Keyboard Wedge			RS232		
	Indicator	Buzzer	For Good Red	For Good Red			For Good Red		
		LED	Dual Color, green and red	Dual Color, green and orange			Dual Color, green and red		
	Languages Support	English(US), English(UK), French, Italian, Belgian, German, Norwegian/Swedish, Spanish, Portuguese. Others on demand.		English(US), English(UK), French, Italian, Belgian, German, Norwegian/Swedish, Spanish, Portuguese. Others on demand.					
Performance	Read card						Track 1	Track2	Track3
	Bit per character						210 bpi	75 bpi	210 bpi
	Capacity character						7	5	5
	Coercive force	Read 300-4000 Oe Mag .card					79	40	107
	Card Thickness	0.76 ~ 1.2 mm		0.25 ~ 1.2 mm			Read 300-4000 Oe Mag .card		
	Read Speed	STD card jitter+/-15% Amp.60% 5 ~ 55ips	5 ~ 50ips	5 ~ 50ips	10 ~ 140 cm (4 ~ 55ips)		Read/Write 300-4000 Oe Mag .card		
	Write Speed						Write 300-600 Oe Mag .card		
	Write jitter						5~30ips		
	Error rate	Read < 0.5%					Interval<+/-10%, Sub-interval<+/-12%		
	MTBF				100,000 hours		Read < 0.5% Write < 0.8%		
	Head life	500K swipes, 1M life optional			500K swipes		45,000 hours		
	Card life						Min. 500K	Min. 1,000K	
							swipes for both read/write head		
							Min. 5,000 swipes		

Safety & Regulatory Approvals

FCC class-A, CE, C-tick



1023



1024



1030



1036



Dimensions

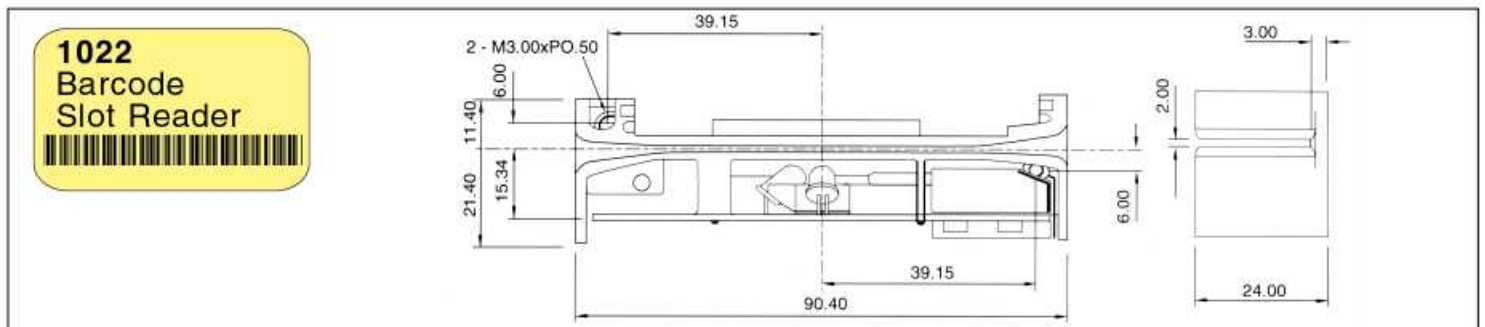
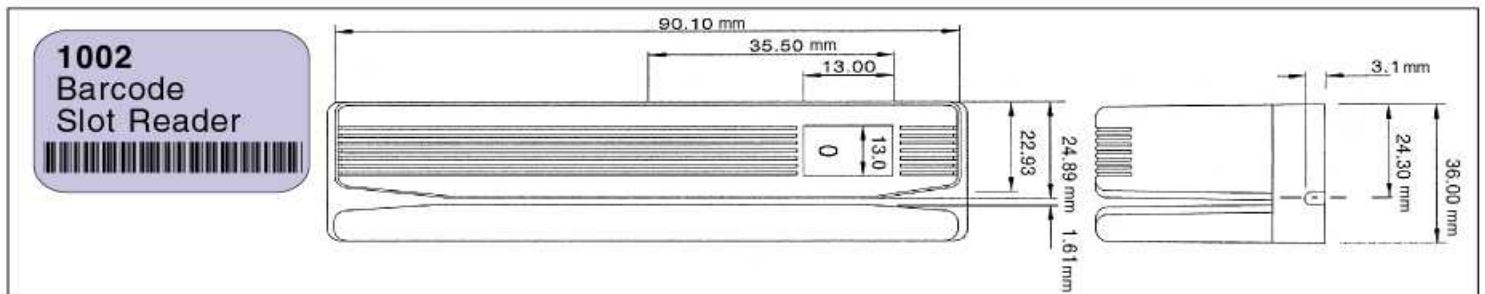
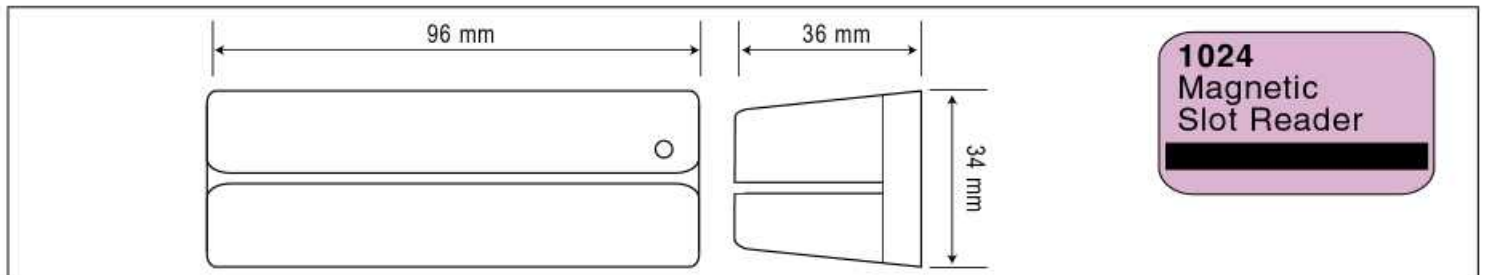
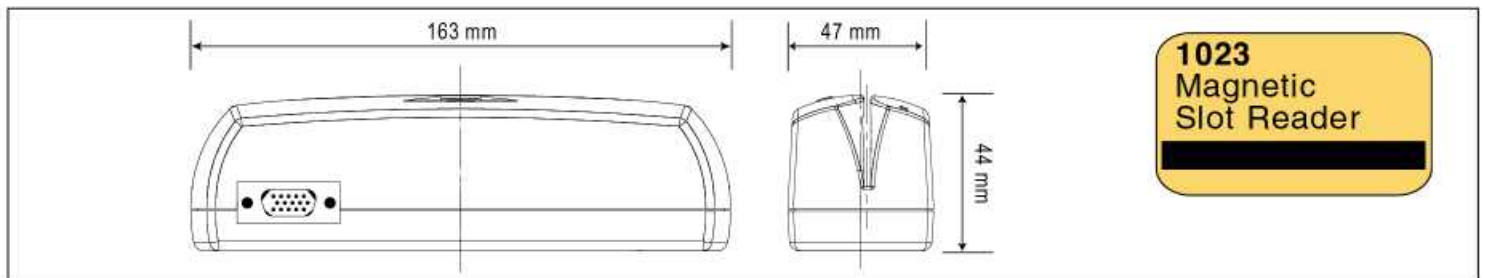
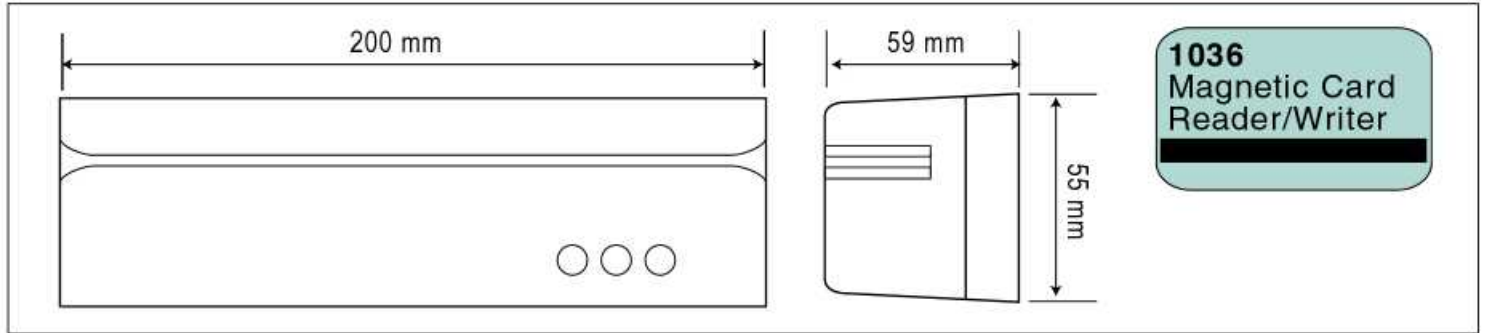
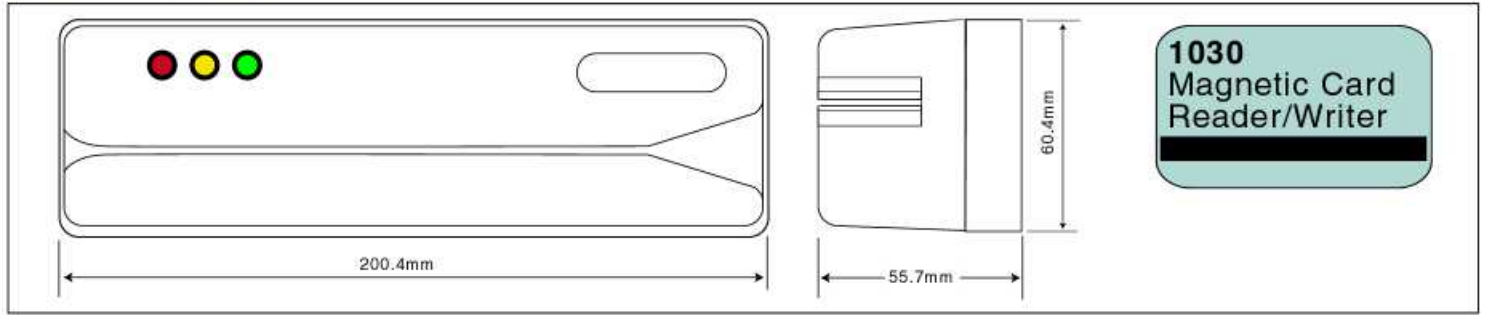

Headquarter
Syntech Information Co., Ltd.
 5F, No. 196-3, Ta-Tung Road
 Sec. 3, Hsi-Chih
 Taipei Hsien, Taiwan
 TEL: +886 2 8647 3300
 FAX: +886 2 8647 1155
www.cipherlab.com.tw

USA
Syntech West Inc.
 3404 57th Street NW Suite B
 Gig Harbor, WA 98335
 U.S.A.
 TEL: +1 253 858 7906
 FAX: +1 253 858 7713
www.cipherlab.com